



allestimento & arredamento  
ladenbau & einrichtung  
shop fitting & interiors



## allestimento & arredamento

**IT** tutto e ancor di più per l'allestimento di negozi e per eventi: mobili completi, accessori e complementi modulari per l'arredo e l'allestimento creativo

## ladenbau & einrichtung

**DE** alles für die komplettausstattung von shops wie events: fertiges mobilair, zubehör und modulare komponenten für die ganz individuelle einrichtung und den kreativen ladenbau.

## shop fittings & interiors

**EN** all for the complete fitting of shops and events: ready to use furniture, accessories and modular components for very individual interiors and the creative shop fitters

soistes 340-345	soistes profile 346-347	soistes bases & accessories 348-349	soistes trays 350-351	soistes accessories 352-353	fly design & fly style 354-355	soistes accessories 356-358	cart soistes 359

ripiano 360-361	sarto soistes 362	store soistes 363	connector 364	vista soistes 365	vetrina top 366	vetrina 367	miura stool & table 368

wave & rondo 369	space 370	ping meets pong 371



## showroom

fissoblister display 372	counter display fissovisto 372	sample case fisso & fly 372	sample case soistes 373	sample case ix bond 373	angelframe sample 374	monsterframe sample 374	digi & mypressto display 374

bannerboy display 375	fisso & fly panel 375	fisso wall panel 375	fly panel 375





# soistes® profile yourself!®

italian design by KD



**IT** questo sistema, tanto semplice quanto geniale, è nato dalle sollecitazioni che ci presenta l'architettura moderna, con i suoi vasti open space realizzati in vetro e in metallo: per queste esigenze c'è bisogno di un sistema universale e completo, che sia modulare e che si possa utilizzare come allestimento autoportante o mobile, avendo allo stesso tempo la possibilità di essere applicato a parete e a soffitto. deve essere inoltre un sistema elegante e trendy che permetta di arredare gli spazi vuoti e di rappresentare uno strumento di presentazione, facile e veloce da montare. sembra quasi la quadratura del cerchio? sì, è proprio SOISTES (che significa „é così“)! venite a scoprire nelle prossime pagine tutto quello che potrete creare con le strutture soistes.

**DE** geboren ist dieses einfache wie geniale system aus der herausforderung, die uns moderne architektur mit ihrem grosszügigen open space in glas und metall stellt: hier braucht es ein durchgängiges und universelles system, das sich modular freistehend oder mobil aufbauen lässt und zudem für die wand- und deckenmontage geeignet ist. es soll ausserdem trendiges ambiente für einrichtung wie präsentation bieten und dennoch schnell und unkompliziert zu montieren sein. fast schon die quadratur des kreises? ja, genau SOISTES! entdecken sie auf den folgenden seiten was und wieviel sie mit soistes strukturen alles realisieren können.

**EN** this simple but ingenious system was born out of the challenges that modern architecture gives us, with its huge open spaces in metal and glass: the need for a universal system, that can be freestanding or mobil, that can be mounted to the wall or suspended from the ceiling, that creates a trendy ambience for interior decoration and presentation as well and that can be mounted quickly and easily. in short: a solution of striking simplicity for complex and multiple demands, which we called SOISTES. discover on the following pages what and especially how much you can realize with soistes structures.

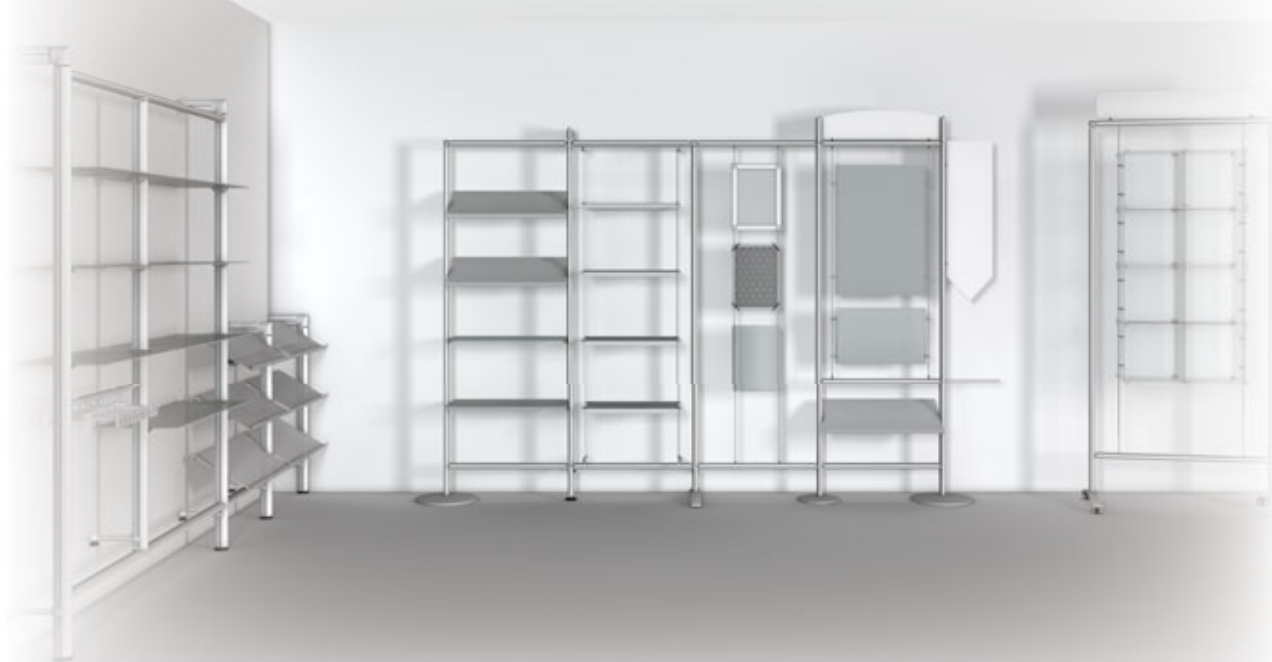



© by nelservice.cc media ag nelservice messepark



### richiedete adesso il vostro catalogo!

**IT** nel nostro nuovo catalogo troverete informazioni esaurienti su tutto ciò che potrete realizzare con soistes

### bestellen sie jetzt ihr exemplar!

**DE** ausführliche info und was sie alles mit soistes noch machen können, finden sie im neuen katalog

### order your copy now!

**EN** for detailed information and what else you can do with soistes, is all in the new catalogue

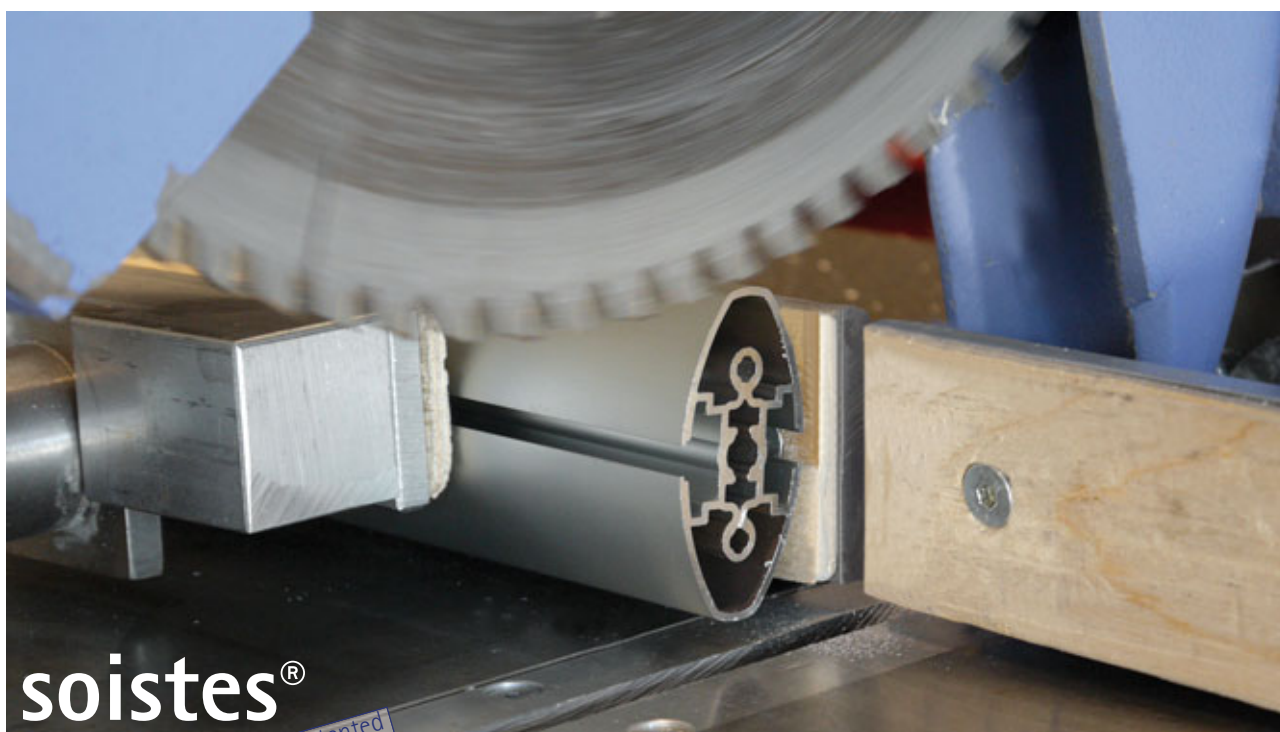

soistes®

patented

## profile yourself!®



© by nelservice.cc media og nelservice messepark

**IT** i nuovi trend e le richieste del mercato oggi influenzano sempre di più l'arredamento e gli allestimenti in genere. questo richiede un sistema dinamico che si adegui in modo flessibile, rapido e funzionale. soistes è semplice da montare e si adatta a tutte le esigenze dello spazio che ha intorno. i materiali selezionati sono resistenti all' utilizzo quotidiano il tutto senza tralasciare una cura estetica moderna ed elegante. prendete spunto dai prodotti standard della linea soistes per approfondire la gamma attraverso un sistema modulare per l'arredo con il quale realizzerete le vostre idee.

**DE** ladenbau wie einrichtung unterliegen immer schneller neuen trends und marktforderungen. hier ist ein system gefordert, das schnell, flexibel und anpassungsfähig ist. soistes ist nicht nur einfach aufzubauen, es passt sich auch räumlichen gegebenheiten an. die ausgesuchten materialien halten täglichen belastungen stand und sind dennoch leicht in ihrer anmutung. abgesehen von den fertigungsmodule, bietet soistes ihnen die ganze palette eines modularen baukastensystems, mit dem sie ihre einrichtungsideen im handumdrehen realisieren.

**EN** shop fitting and interiors vary according to new trends and market needs. this requirement asks for a system that is quick, flexible and can be applied to any situation. not only is soistes easily assembled, but it also adapts well to surrounding spatial needs. the materials selected withstand daily usage while still looking stylish and modern. in addition to the standard ready made articles, the soistes range gives you all of the advantages of a modular system, turning your ideas easily into reality.





patented

profile yourself!®

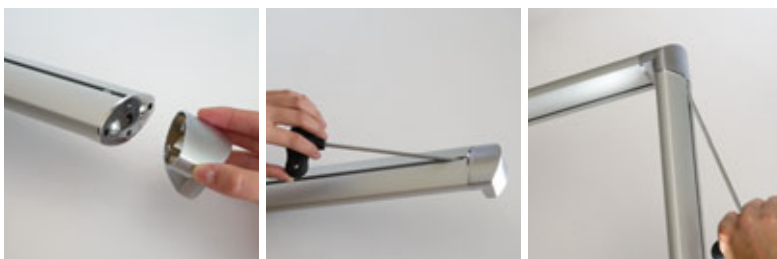
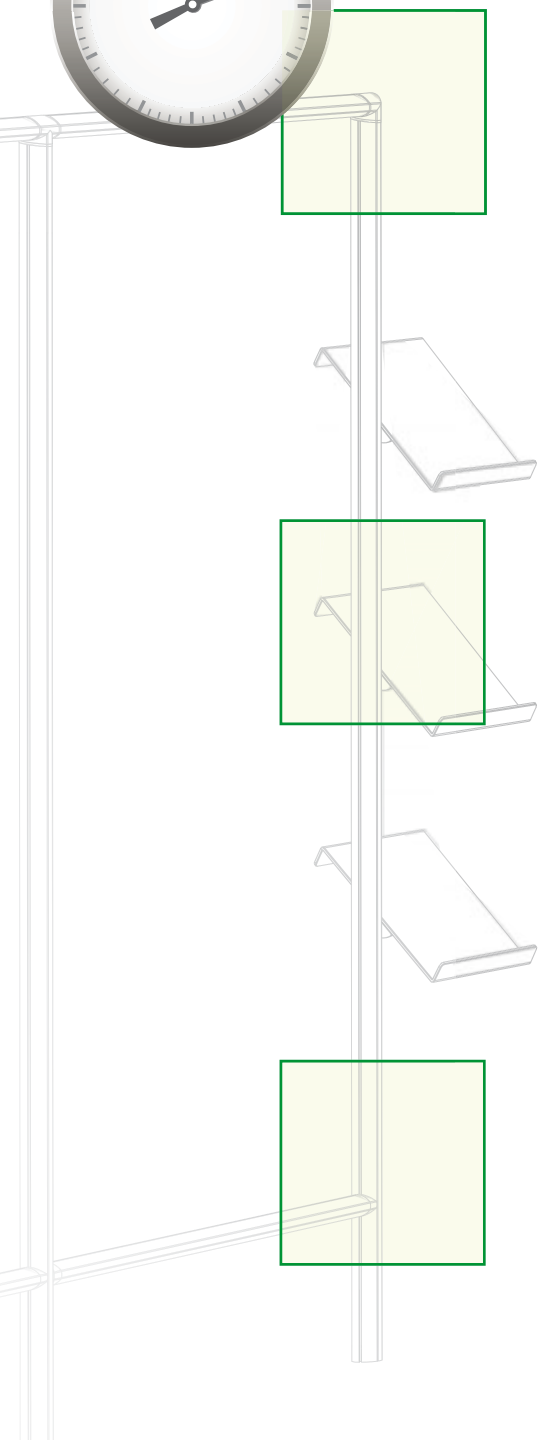
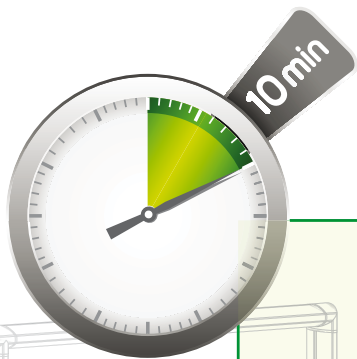

i connettori angolari costituiscono le giunzioni per costruire la struttura base  
mit den eckverbindern wird die grundstruktur aufgebaut.  
the basic structure is assembled using edge connectors

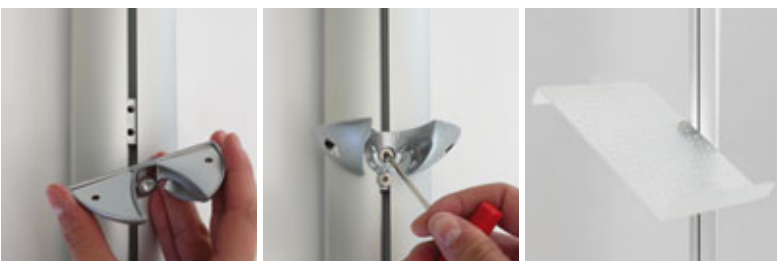

dadi filettati per montare i ripiani regolabili in inclinazione ed altezza  
nutsteine mit gewinde für die ablagenmontage, stufenlos höhenverstellbar  
threaded nuts for the mounting of the trays, adjustable in height and inclination



semplice e sicuro il montaggio delle traverse per una perfetta stabilità  
einfache querstrebenmontage sorgen für hohe stabilität  
easy to mount cross braces give high stability



**soistes<sup>®</sup>**

italian design by KD





**IT** nelle pagine seguenti troverete tutti gli accessori necessari quali profili, connettori, angolari, piedini di appoggio, ruote e basi per la libera composizione della vostra personalissima struttura soistes. nell'ultima parte di questa sezione troverete inoltre la gamma completa di ripiani, scaffali, portaoggetti, portaposter e sistemi di fissaggio a disposizione per il completamento delle vostre creazioni con soistes.

**DE** auf den folgenden seiten finden sie alle erforderlichen profile, eckverbinder, füsse, rollen und basen für den bau ihrer ganz persönlichen soistes struktur. und im letzten teil gibt es alle ablagen, fachböden, objektträger, postertaschen und die erforderlichen befestigungen für sie zur auswahl.

**EN** on the following pages you find all the single components such as extrusions, edge connectors, feet, wheels and bases to set up your very own soistes structure, and in the last chapter you find a large variety of shelves, boards, trays, poster pockets and the required mounting supports for you to choose from.





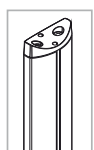

- 1 1700mm
- 2 1900mm
- 3 2100mm
- 4 2300mm
- 5 2500mm
- 6 2800mm
- 7 3000mm



- 8 640mm
- 9 900mm
- 10 1200mm
- 11 1500mm
- 12 1800mm
- 13 2000mm
- 14 2500mm

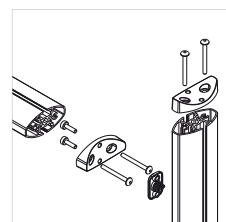

**IT** grazie a questi moduli pre-assemblati di o-profili con connettori, le creazioni ed il montaggio di una struttura base soistes sono davvero semplici e veloci: basta scegliere l'altezza e la larghezza desiderata e il tipo di angolare in alto (frame A: terminale ad angolo retto e frame B: a traversa).

**DE** mit diesen bereits abgelängten und mit verbindern vormontierten profil-O-modulen ist der aufbau der soistes grundstruktur ganz unkompliziert: einfach gewünschte höhe und breite sowie art des oberen eck-abschlusses (frame A überstehend, frame B bündig) auswählen.

**EN** with these pre-cut extrusion modules and with connectors pre-assembled, the set up of the soistes basic structure is really convenient and easy: just choose the required height and width and which kind of corner connection (frame A overlying, frame B flush).

# soistes profile

frame A

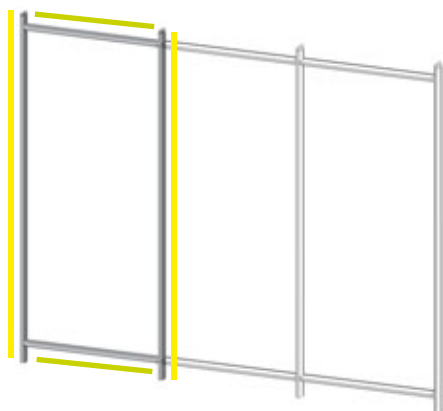

included



## frame A

n° articolo | artikelnr. | product nr.

1	SOFA1700V	frameA V 1700mm,1pc	51,00€
2	SOFA1900V	frameA V 1900mm,1pc	66,00€
3	SOFA2100V	frameA V 2100mm,1pc	60,00€
4	SOFA2300V	frameA V 2300mm,1pc	64,00€
5	SOFA2500V	frameA V 2500mm,1pc	69,00€
6	SOFA2800V	frameA V 2800mm,1pc	75,50€
7	SOFA3000V	frameA V 3000mm,1pc	80,00€
8	SOFAB640Q	frameA/B Q 640mm, 1pc	28,00€
9	SOFAB900Q	frameA/B Q 900mm, 1pc	34,00€
10	SOFAB1200Q	frameA/B Q 1200mm, 1pc	44,00€
11	SOFAB1500Q	frameA/B Q 1500mm, 1pc	51,00€
12	SOFAB1800Q	frameA/B Q 1800mm, 1pc	58,00€
13	SOFAB2000Q	frameA/B Q 2000mm, 1pc	62,00€
14	SOFAB2500Q	frameA/B Q 2500mm, 1pc	73,00€

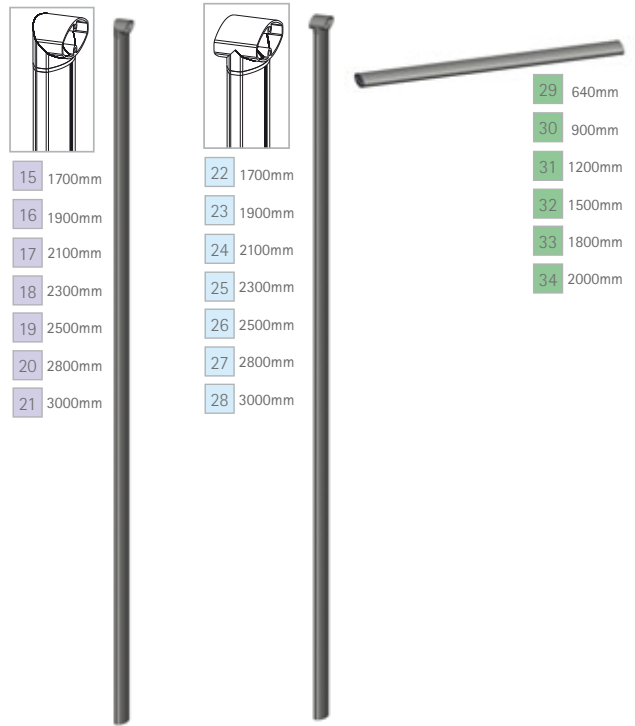
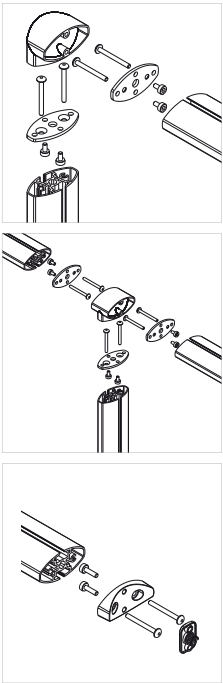

# soistes profile

frame B

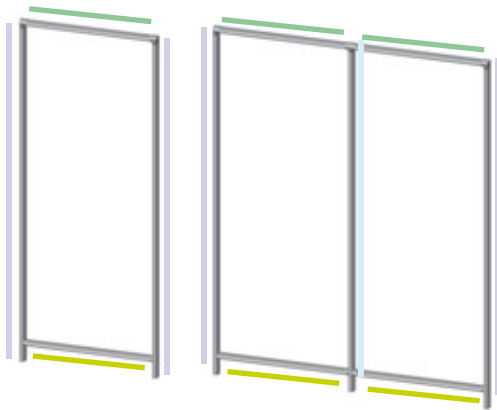

included



## frame B

n° articolo   artikelnr.   product nr.			
15	SOFB1700VE	frameB VE 1700mm, 1pc	55,00€
16	SOFB1900VE	frameB VE 1900mm, 1pc	59,50€
17	SOFB2100VE	frameB VE 2100mm, 1pc	64,00€
18	SOFB2300VE	frameB VE 2300mm, 1pc	69,00€
19	SOFB2500VE	frameB VE 2500mm, 1pc	73,00€
20	SOFB2800VE	frameB VE 2800mm, 1pc	80,00€
21	SOFB3000VE	frameB VE 3000mm, 1pc	85,00€
22	SOFB1700VM	frameB VM 1700mm, 1pc	55,00€
23	SOFB1900VM	frameB VM 1900mm, 1pc	59,50€
24	SOFB2100VM	frameB VM 2100mm, 1pc	64,00€

n° articolo   artikelnr.   product nr.			
25	SOFB2300VM	frameB VM 2300mm, 1pc	69,00€
26	SOFB2500VM	frameB VM 2500mm, 1pc	73,00€
27	SOFB2800VM	frameB VM 2800mm, 1pc	80,00€
28	SOFB3000VM	frameB VM 3000mm, 1pc	85,00€
29	SOFB640Q	frameB Q 640mm, 1pc	25,00€
30	SOFB900Q	frameB Q 900mm, 1pc	31,00€
31	SOFB1200Q	frameB Q 1200mm, 1pc	40,00€
32	SOFB1500Q	frameB Q 1500mm, 1pc	47,00€
33	SOFB1800Q	frameB Q 1800mm, 1pc	54,00€
34	SOFB2000Q	frameB Q 2000mm, 1pc	58,00€

# soistes bases



**11** SOBS330AR base 330  
base con rivestimento esterno di protezione in ABS, color argento, inserto decorativo in alluminio anodizzato, color argento  
versilberter abs-trittschutzring mit silber eloxierter aluminium-dekorscheibe  
silver-plated abs-step-on-protection ring, silver anodised aluminium decorative inlay

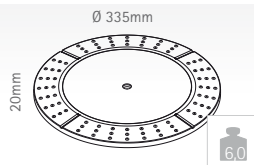

**12** SOBS240 base 240  
base con rivestimento esterno di protezione in ABS colore grigio, inserto decorativo in alluminio anodizzato, color argento  
grauer abs-trittschutz-ring mit silber eloxierter aluminium dekor-scheibe  
grey abs-step-on-protection ring with silver anodised aluminium decorative inlay

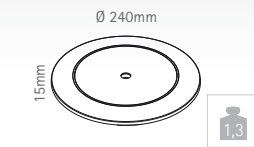

**13** SOEB330GR base eco  
base in abs, grigio chiaro  
lichtgraue abs-kunststoff-basis  
light-grey synthetic base

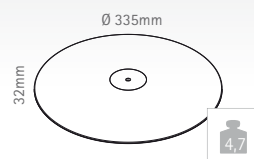

**14** SOPU60SZ plug  
piedini di appoggio in gomma rigida, nera, con perno filettato  
hartgummi-fuss, schwarz mit gewinde  
hard rubber foot, black with thread

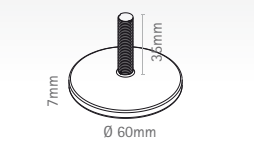

**15** SOPI430AR piede  
base realizzata in metallo a pressofusione color argento, con appoggi antiscivolo, nero  
fuss aus versilbertem metall-druckguss, mit schwarzen anti-rutsch pads aus kunststoff  
foot made of silver-plated metal die-cast, with black anti-slip pads

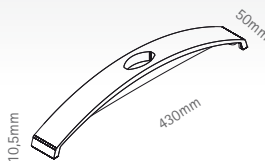

**16** SORO35 roller  
ruota doppia nera in PA ricoperta in TPU, per montaggio con base piede (2pz cad).  
leichtlaufrollen aus PA schwarz, TPU auflage, zur montage auf fuss piede (je 2stück).  
smooth wheels in black PA with TPU overlay, for mounting to the base piede (2pcs each).

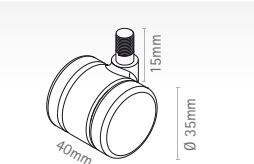

**17** SOPD40SZ pad  
piedini di appoggio in gomma rigida nera, per il montaggio con la base piede (2pz cad).  
hartgummi-fuss schwarz, zur montage auf fuss piede (je 2stück).  
hard rubber foot, black, for mounting to the base piede (2pcs each).

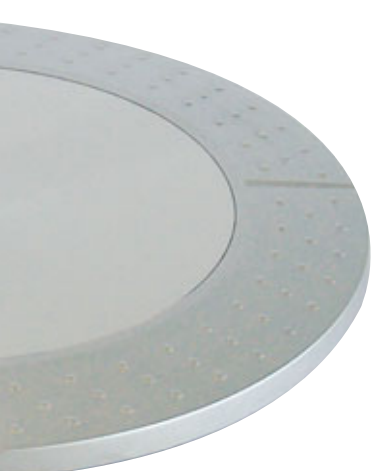
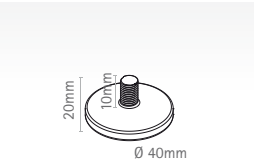

## soistes components

n° articolo   artikelnr.   product nr.			
11	SOBS330AR	base 330, 1pc	78,00€
12	SOBS240	base 240, 1pc	29,00€
13	SOEB330GR	base eco, 1pc	45,00€
14	SOPU60SZ	plug, box 4pcs	5,50€
15	SOPI430AR	piede, 1pc	26,00€
16	SORO35	roller, box 4pcs	13,00€
17	SOPD40SZ	pad, box 4pcs	5,00€

# soistes accessories

combinations

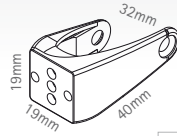

included



**SOPZ1940AR** pinza

supporto per il montaggio laterale del ripiano tray 4 S, realizzato in metallo a pressofusione, color argento.

halter für tray 4 S bei lateraler Befestigung, versilberter metall-druckguss.

support for lateral mounting of tray 4 S. silver-plated metal die-cast.

1



combinations

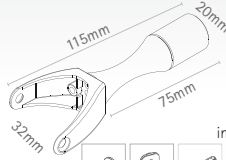

included



**SOPG32115AR** peg

supporto a parete per o-profil, distanza dal muro 75mm, realizzato in metallo a pressofusione, color argento.

wandhalter für o-profil wandabstand 75mm. versilberter metall-druckguss.

wall support for o-profil with wall distance 75mm. silver-plated metal die-cast

2



combinations

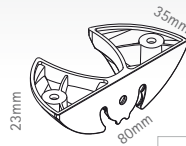

included



**SOPM8035AR** palm

supporto inclinabile per ripiani realizzato in metallo a pressofusione, color argento.

ablagenhalter, drehbar, versilberter metall-druckguss.

tray-support, inclinable, silver-plated metal die-cast

3



combinations

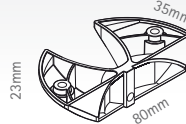

included



**SOHO8035AR** hold

supporto per ripiani realizzato in metallo a pressofusione, color argento.

ablagenhalter, versilberter metall-druckguss.

tray-support, silver-plated metal die-cast

4



combinations

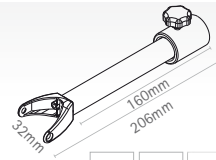

included



**SOAR32206AR** arm

sostegno a parete per o-profil, distanza dal muro 206mm, realizzato in metallo a pressofusione, color argento

wandhalter für o-profil wandabstand 206mm. versilberter metall-druckguss.

wall support for o-profil with wall distance 206mm. silver-plated metal die-cast

5



combinations

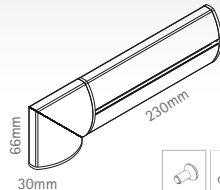

included



**SOWHOP162** ofix

sostegno a parete per o-profil, da combinare con arm

wandhalter für o-profil in kombination mit befestigung arm.

wall support for o-profil, in combination with support arm

6



**SODD1010SY** nuts

dado ad incastro, per montare pannelli leggeri con viti autofilettanti

einklickmutter, für montage leichter paneele mit blechschrauben

nut, to mount lightweight panels with self tapping screws

7



## soistes accessories

n° articolo | artikelnr. | product nr.

1	<b>SOPZ1940AR</b>	pinza, 1pc	<b>4,60€</b>
2	<b>SOPG32115AR</b>	peg, 1pc	<b>17,00€</b>
3	<b>SOPM8035AR</b>	palm, 1pc	<b>5,50€</b>
4	<b>SOHO8035AR</b>	hold, 1pc	<b>6,00€</b>

5	<b>SOAR32206AR</b>	arm, 1pc	<b>15,00€</b>
6	<b>SOWHOP162</b>	ofix, 1pc	<b>19,00€</b>
7	<b>SODD1010SY</b>	nuts, box 100pcs	<b>11,00€</b>



340-345 346 348 352 354 356 359 360 362 363 364 365 366 367 368 369 370 371

# soistes trays

<p>1</p>	<p><b>SOTRA4TR</b>            ripiano A4, policarbonato stampato ad iniezione, montaggio laterale singolo o doppio.            A4 ablage aus schlagfestem polycarbonat spritzguss für seitliche, ein- und beidseitige montage            single tray made of shock-resistant polycarbonate die-cast for DIN A4 format. for lateral single or double sided mounting.</p>		<p>combinations</p> <p>346 349 3</p>
<p>2</p>	<p><b>SOTRA4STR</b>            ripiano A4, policarbonato stampato ad iniezione, supporto in alluminio anodizzato per montaggio frontale su o-profil incluso.            A4 ablage aus schlagfestem polycarbonat spritzguss incl. silber eloxiertem aluminium halter für frontale montage auf o-profil.            A4 tray made of polycarbonate die-cast incl silver anodised support for front mounting to o-profil.</p>	<p>included</p>	<p>combinations</p> <p>349 1 346</p>
<p>3</p>	<p><b>SOTR2A4TR</b>            ripiano in acrilico satinato per 2 formati DIN A4 verticali            ablage aus satiniertem acryl. für 2 DIN A4 formate.            tray made of satin acrylic. for 2 DIN A4 format.</p>	<p>included</p>	<p>combinations</p> <p>346</p>
<p>4</p>	<p><b>SOTR650TR</b>            ripiano in acrilico satinato per 3A4 verticali, per giornali o riviste di formato più grande.            ablage aus satiniertem acryl für 3 A4 oder grossformatige zeitungen.            tray made of satin acrylic, place for 3 A4 formats or large format newspapers.</p>	<p>included</p>	<p>combinations</p> <p>346</p>
<p>5 6</p>	<p><b>SOVE650</b>  <b>SOVE910</b>            ripiano in vetro temperato, spessore 8mm. fondo satinato e con il marchio. disponibile in due misure            fachboden aus temperiertem 8mm starkem glas. unterseite satiniert mit markenzeichen. 2 grössen zur auswahl.            shelf made of tempered 8mm thick glass. rear side satined and brand marked. available in 2 sizes.</p>	<p>included</p>	<p>combinations</p> <p>346</p>

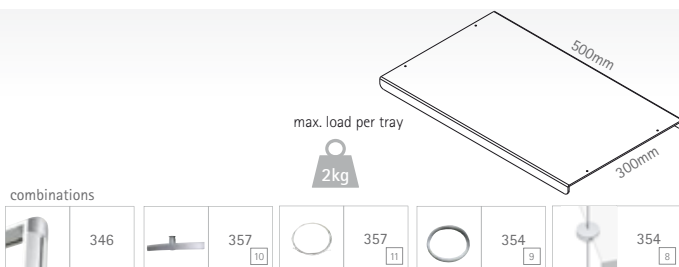

#### SOTR500TR

ripiano in acrilico satinato per il montaggio a sospensione sui cavi di acciaio. arc, pod e cavo di acciaio da ordinare separatamente.  
 fachboden aus satiniertem acryl für befestigung am spannseil arc, pod und gewünschtes seil extra bestellen.  
 shelf made of satin acrylic for suspension. for mounting order arc, pod and wire extra.

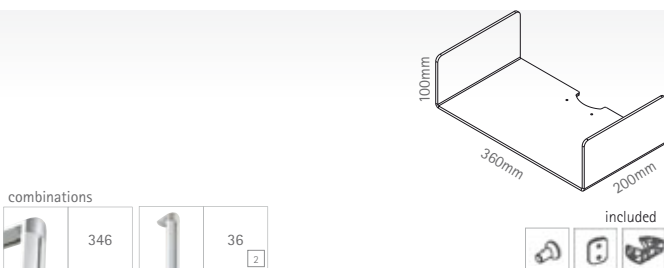

#### SOTR360UTR

ripiano in acrilico satinato per il montaggio frontale sul o-profil.  
 ablage aus satiniertem acryl für frontale montage auf o-profil.  
 shelf made of satin acrylic for front mounting to o-profil.

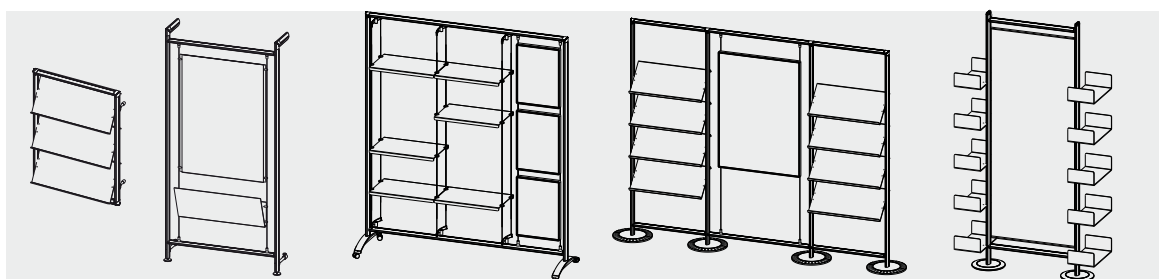
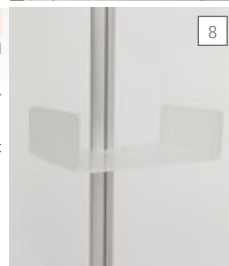

## soistes shelves

n° articolo | artikelnr. | product nr.

1	SOTRA4TR	tray A4, 1pc	15,00€
2	SOTRA4STR	tray A4S, 1pc	33,00€
3	SOTR2A4TR	tray2 A4, 1pc	39,00€
4	SOTR650TR	tray 650, 1pc	58,00€
5	SOVE650	glass 650, 1pc	38,00€
6	SOVE910	glass 910, 1pc	49,00€
7	SOTR500TR	tray 500, 1pc	21,00€
8	SOTR360UTR	tray 360 U, 1pc	36,00€





# soistes accessories



- SOPS5037 post
- SORD650 rod 650mm
- SORD900 rod 900mm
- SORD1500 rod 1550mm

per banner con orlo: barre rod e appoggio post, alluminio anodizzato, metallo pressofuso color argento.

für banner mit saum: rod stangen und auflagenhalter post. silber eloxiertes alu und versilberter metalldruckguss

for banners with seams: rod bars and support post. silver anodised aluminium and silver-plated metal die-cast.

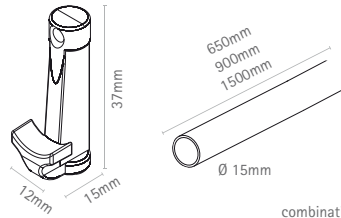
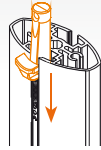

included



combinations

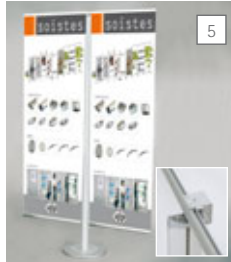

SOTW400

supporto e profili a scatto bannerblock per 2 banner con larghezza 400mm. unico profilo in alto, in basso in 2 pezzi.

halter und klemmprofil bannerblock für 2 banner je 400mm breite. oberes profil durchgehend, unteres geteilt. support and extrusions bannerblock for 2 banner with 400mm width. upper extrusion end to end, bottom extrusions separated.

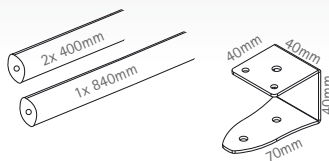

included



combinations



AGK60TR

ACL3540WE

SONB15AR

per il montaggio dei banner senza occhielli

für bannerbefestigung ohne ösen. for banner mounting without eyelets

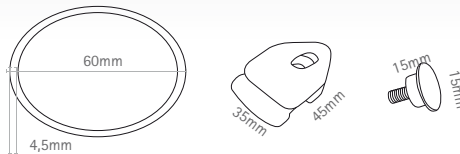

included



combinations

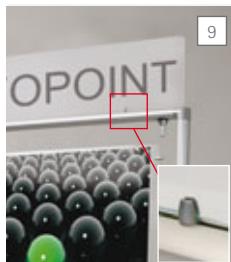

SOCF1515AR

morsetto per il montaggio di crowner con uno spessore massimo di 4mm, ottone color argento

zur befestigung von topschildern mit max. 4mm stärke aus versilbertem messing. for crowner panels mounting with max. 4mm thickness made of silver-plated brass.

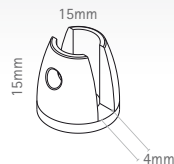

included



combinations



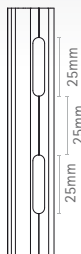

SOGL1500 1500mm

SOGL1700 1700mm

profilo alluminio anodizzato  
silber eloxiertes aluminium profil  
silver anodized aluminium profile

10 11



**IT** arricchite la vostra gamma di complementi per l'arredo negozi con il nuovo soistes global, il profilo per appendere accessori ed attrezzature per negozi: nelle fresature di global, infatti, trovano posto i più comuni supporti per ripiani e scaffali. global deve essere inserito nella cava del profilo prima del montaggio della struttura soistes. siamo a disposizione per soddisfare ogni vostra curiosità al riguardo.

**DE** erweitern sie mit dem profil global ihr soistes system für ladenbau-accessoires zum einhängen: in die fräsungen passen gängige ablagenhalter. global muss vor montage des soistes systems eingebaut werden. fragen sie uns, wir beraten sie gerne.

**EN** upgrade your soistes systems with the global profile for attachable shopfitting accessories: the notches are made for supports of shelves and / or trays. global must be installed before mounting the soistes system. ask us, we are happy to assist you.



combinations



## soistes accessories

n° articolo | artikelnr. | product nr.

1	SOPS5037	post, set 4 pcs	8,50€
2	SORD650	rod 650mm, 1pc	13,00€
3	SORD900	rod 900mm, 1pc	16,00€
4	SORD1500	rod 1500mm, 1pc	25,00€
5	SOTW400	twin 400, 1set	43,00€
6	AGK60TR	silicone o-ring, box 20pcs	25,75€
7	ACL3540WE	clamp, box 20pcs	20,00€
8	SONB15AR	nob, box 20pcs	43,00€
9	SOCF1515ARSET	crownrefix, set 2pcs	10,30€
10	SOGL1500 *	global 1500mm, 1pc	21,00€
11	SOGL1700 *	global 1700mm, 1pc	23,50€

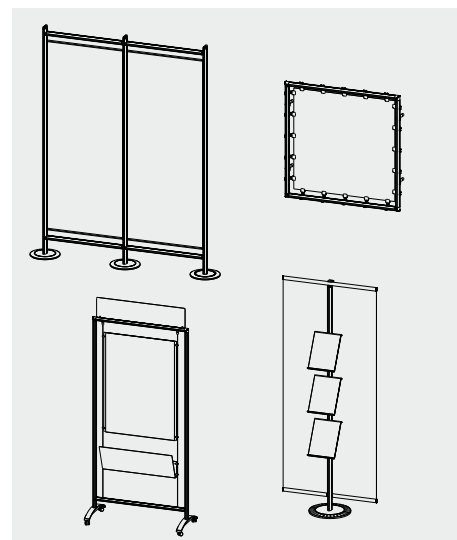

\* in vendita da febbraio 2011 | auslieferung ab februar 2011 | on sale from february 2011



# soistes accessories



**1 SOFX3035ARSET**  
 tirante per cavi, ottone color argento  
 seilhalter mit schraubhülse, messing versilbert  
 cable support with screw sleeve, silver-plated brass

max. ø1,7 mm

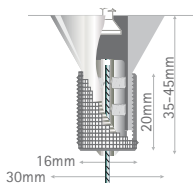

**6 YFR1315ARSET**  
 morsetto regolabile, montaggio frontale su cavi, ott. col. argento  
 paneelhalter regulierbar, frontmontage, messing versilbert  
 flexible panel support front mounting, silver-plated brass

max. ø1,7 mm

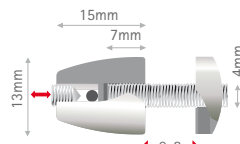

**2 YTG1329ARSET**  
 pinza laterale per cavi, ottone color argento  
 paneelhalter für seil, messing versilbert  
 panel support for cable, silver-plated brass

max. ø1,7 mm

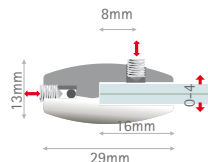

**7 YBK1320ARSET**  
 pinza con filetto per cavi, ottone color argento  
 paneelhalter mit gewinde für seil, messing versilbert  
 panel support with thread for cable, silver-plated brass

max. ø1,7 mm

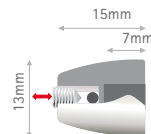

**3 YHO1329ARSET**  
 pinza laterale regolabile per cavi, ottone color argento  
 paneelhalter regulierbar für seil, messing versilbert  
 flexible panel support for cable, silver-plated brass

max. ø1,7 mm

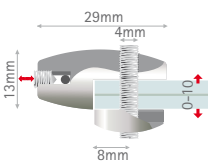

**8 SOPO30ARSET**  
 supporto per ripiani su cavi, ottone color argento  
 fachbodenhalter für seil, messing versilbert  
 shelf support for cable, silver-plated brass

max. ø1,7 mm

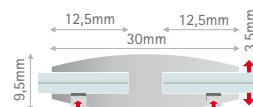

**4 YCO1340ARSET**  
 pinza laterale doppia per cavi, ottone color argento  
 doppel-paneelhalter für seil, messing versilbert  
 double panel support for cable, silver-plated brass

max. ø1,7 mm

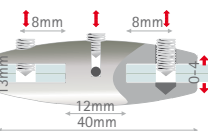

**9 AFIL05**

**10 AFIL25**

cavo di acciaio rivestito in pvc  
 stahlseil mit pvc beschichtung  
 steel wire pvc coated



**5 YBR1340ARSET**  
 pinza laterale doppia regolabile, ottone color argento  
 doppel-paneelhalter für seil regulierbar, messing versilbert  
 flexible double panel support for cable, silver-plated brass

max. ø1,7 mm

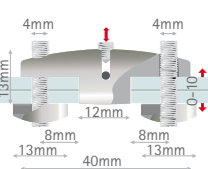

## soistes accessories

n° articolo   artikelnr.   product nr.			
1	<b>SOFX3035ARSET</b>	soistes fix, set 2pcs	<b>10,20€</b>
2	<b>YTG1329ARSET</b>	tengo, set 4pcs	<b>16,75€</b>
3	<b>YHO1329ARSET</b>	hold, set 4pcs	<b>22,60€</b>
4	<b>YCO1340ARSET</b>	coppia, set 4pcs	<b>19,40€</b>
5	<b>YBR1340ARSET</b>	brace, set 4pcs	<b>31,50€</b>
6	<b>YFR1315ARSET</b>	front, set 4pcs	<b>17,70€</b>
7	<b>YBK1320ARSET</b>	beak, set 4pcs	<b>12,50€</b>
8	<b>SOPO30ARSET</b>	pod, set 4pcs	<b>26,00€</b>
9	<b>AFIL05</b>	afil, 5m	<b>8,60€</b>
10	<b>AFIL25</b>	afil, 25m	<b>19,50€</b>

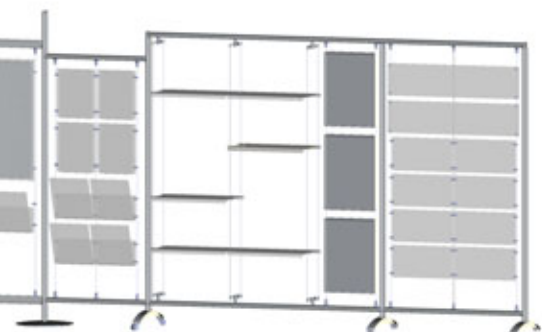

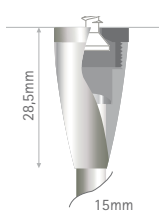

**SOF01529CMSET**  
 tirante per astine, ottone color cromo lucido  
 halter für stange, messing verchromt  
 ceiling support for bars, chrome-plated brass

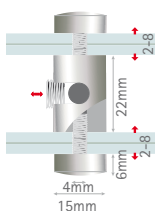

**YCS1527CMSET**  
 morsetto frontale per 2 pannelli su astine, ottone cromo  
 doppelpaneel-halter für stange, messing verchromt  
 front double panel support for bars, brass chrome-plated

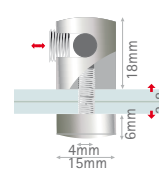

**YWS1525CMSET**  
 morsetto frontale per pannelli su astine, ottone cromo  
 paneel-halter für stange, messing verchromt  
 front panel support for bars, brass chrome-plated

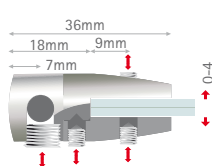

**YMI1536CMSET**  
 pinza laterale per pannelli su astine, ottone cromo  
 seitlicher paneel-halter für stange, messing verchromt  
 lateral panel support for bars, brass chrome-plated

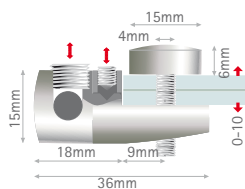

**YWS1545CMSET**  
 pinza laterale regol. per pannelli su astine, ottone cromo  
 seitlicher paneel-halter für stange, messing verchromt  
 lateral panel support for bars, brass chrome-plated

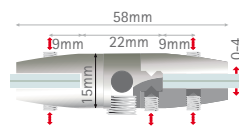

**YDP1538CMSET**  
 pinza laterale doppia per pannelli su astine, ottone cromo  
 seitlicher doppelpaneel-halter für stange, messing verchromt  
 double lateral panel support for bars, brass chrome-plated

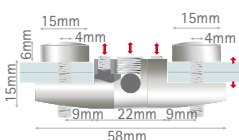

**YWS1568CMSET**  
 pinza laterale doppia regol. per pannelli su astine, ottone cromo  
 seitlicher doppelpaneel-halter für stange, messing verchromt  
 double lateral panel support for bars, brass chrome-plated

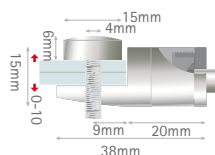

**YCS1535CMSET**  
 pinza regol. per pannelli su astine, ottone color cromo  
 paneelhalter für stange, messing verchromt  
 panel support for bars, brass chrome-plated

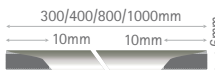

**YWS3006CM**  
**YWS4006CM**  
**YWS8006CM**  
**YWS10006CM**

astine modulari, ottone cromato  
 modulare stangen mit gewinde, messing verchromt  
 modular bars with threads, croma brass



## soistes accessories

n° articolo | artikelnr. | product nr.

11	<b>SOF01529CMSET</b>	soistes forte, set 2pcs	<b>20,20€</b>
12	<b>YCS1527CMSET</b>	profi, set 4pcs	<b>27,50€</b>
13	<b>YWS1525CMSET</b>	maestro, set 4pcs	<b>22,70€</b>
14	<b>YMI1536CMSET</b>	mira, set 4pcs	<b>32,20€</b>
15	<b>YWS1545CMSET</b>	lato, set 4pcs	<b>39,20€</b>
16	<b>YDP1538CMSET</b>	doppio, set 2pcs	<b>24,50€</b>
17	<b>YWS1568CMSET</b>	cupido, set 2pcs	<b>32,00€</b>
18	<b>YCS1535CMSET</b>	amo, set 2pcs	<b>19,80€</b>
19	<b>YWS3006CM</b>	asta, set 2pcs	<b>14,00€</b>
20	<b>YWS4006CM</b>	asta, set 2pcs	<b>16,00€</b>
21	<b>YWS8006CM</b>	asta, set 2pcs	<b>25,00€</b>
22	<b>YWS10006CM</b>	asta, set 2pcs	<b>27,00€</b>

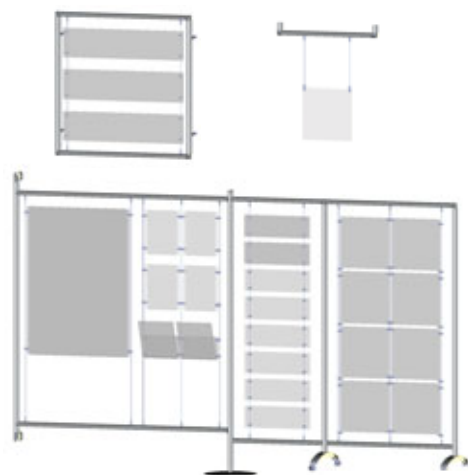



# soistes accessories



**1-4** tasca portaprospetti realizzata in acrilico color trasparente. prospekttasche, transparentes acrylglas  
brochure tray made of transparent acrylic.

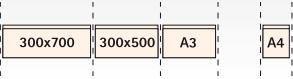

combinations

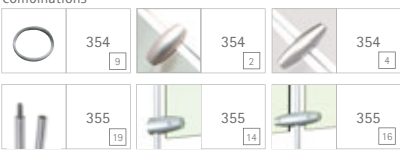





**5-16** tasche per informazioni con chiusura a calamita realizzate in acrilico color trasparente  
info-tasche mit magnetverschluss aus transparentem acryl  
poster pocket with magnetic lock made of transparent acrylic.



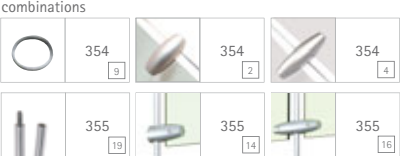

combinations





**17-21** cornice velocemente intercambiabile con chiusura magnetica resistente all'acqua. ordinare separatamente i supporti wire o dot per il montaggio  
schnellwechselrahmen mit wasserabweisendem magnetverschluss. befestigung wire oder dot extra bestellen.  
quick exchange frame with water resistant magnetic lock. order extra support wire or dot for mounting.





mounting on wire    mounting on bars

combinations

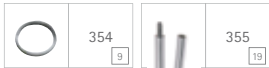

## soistes accessories

n° articolo   artikelnr.   product nr.			
1	<b>YBPA4</b>	flybag A4, 1pc	<b>20,00€</b>
2	<b>YBPA3</b>	flybag A3, 1pc	<b>26,00€</b>
3	<b>YBP500</b>	flybag 300x500mm, 1pc	<b>37,00€</b>
4	<b>YBP700</b>	flybag 300x700mm, 1pc	<b>51,00€</b>
5	<b>YQP1A5H</b>	flyquick A5 horizontal, 1pc	<b>15,80€</b>
6	<b>YQP1A4H</b>	flyquick A4 horizontal, 1pc	<b>23,00€</b>
7	<b>YQP1A4V</b>	flyquick A4 vertical, 1pc	<b>26,00€</b>
8	<b>YQP2A4H</b>	flyquick 2xA4 horizontal, 1pc	<b>42,00€</b>
9	<b>YQP2A4V</b>	flyquick 2xA4 vertical, 1pc	<b>47,00€</b>
10	<b>YQP3A4V</b>	flyquick 3xA4vertical, 1pc	<b>58,00€</b>
11	<b>YQP1A3V</b>	flyquick A3 vertical, 1pc	<b>38,00€</b>
12	<b>YQP1A3H</b>	flyquick A3 horizontal, 1pc	<b>39,50€</b>
13	<b>YQP500700</b>	flyquick 500x700mm, 1pc	<b>84,00€</b>
14	<b>YQP700500</b>	flyquick 700x500mm, 1pc	<b>80,00€</b>
15	<b>YQP7001000</b>	flyquick 700x1000mm, 1pc	<b>129,00€</b>
16	<b>YQP1000700</b>	flyquick 1000x700mm, 1pc	<b>130,00€</b>
17	<b>MADA4</b>	magnedoor A4, 1pc	<b>69,00€</b>
18	<b>MADA3</b>	magnedoor A3, 1pc	<b>79,00€</b>
19	<b>MADA1</b>	magnedoor A1, 1pc	<b>123,00€</b>
20	<b>MAD700500</b>	magnedoor 700x500mm, 1pc	<b>109,00€</b>
21	<b>MAD1000700</b>	magnedoor 1000x700mm, 1pc	<b>146,00€</b>
22	<b>YWI1325ARSET</b>	wire silver set, 4pcs	<b>11,60€</b>
23	<b>YDO1525CMSET</b>	dot chrome set, 4pcs	<b>14,90€</b>

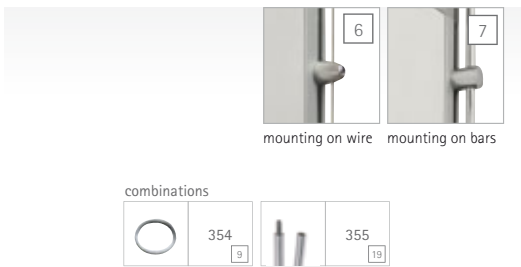

cornice a scatto, ordinare separatamente i supporti wire o dot per il montaggio  
 schnellwechselrahmen, befestigung wire oder dot extra bestellen.  
 quick exchange frame. order extra support wire or dot for mounting.

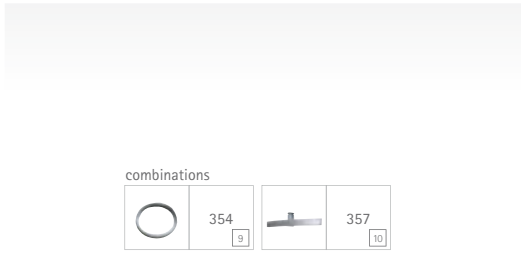

tasca porta informazioni realizzata in policarbonato stampato ad iniezione. supporti per il montaggio a cavo inclusi  
 info-präsentier aus polycarbonat-spritzguss, schnell und einfach zu wechseln. befestigung für seilspannsystem inklusive.  
 information display made of polycarbonate die-cast, quick and easy exchange. mounting supports for wire suspension included.

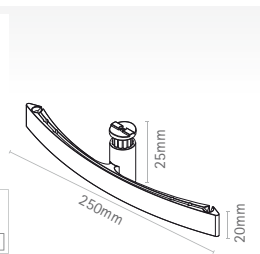

supporto per cavi di acciaio (mass. ø1,7mm) e flystyle asta, metallo a pressofusione color argento  
 befestigung für stahlseil (max. ø1,7mm) und flystyle asta, versilberter metall-druckguss  
 mounting support for steel wire (max. ø1,7mm) and flystyle asta. silver-plated metal die-cast.

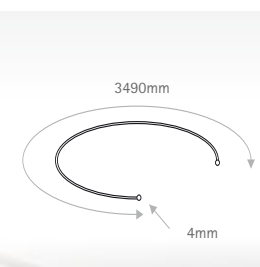
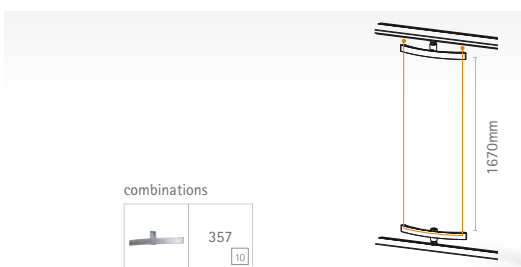

cavo in acciaio inox con sfera pressofusa  
 edelstahlseil mit druckgussnippel  
 stainless steel wire with fitting



## soistes accessories

n° articolo | artikelnr. | product nr.

1	YCLA4	clipper A4, 1pc	30,00€
2	YCLA3	clipper A3, 1pc	37,50€
3	YCLA1	clipper A1, 1pc	76,50€
4	YCL700500	clipper 700x500mm, 1pc	65,00€
5	YCL1000700	clipper 1000x700mm, 1pc	89,90€
6	YWI1325ARSET	wire silver set 4pcs	11,60€

7	YDO1525CMSET	dot chrome set 4pcs	14,90€
8	PQCA4	pixquick for cable A4, 1pc	22,00€
9	PQCA5	pixquick for cable A5, 1pc	17,60€
10	SOAC250AR	arc, set 2pcs	21,00€
11	SOFI3490	filo 3490mm, 1pc	8,50€



# soistes accessories



sistema modulare per ripiani e scaffali; angolari in policarbonato color vetro, ripiani in acrilico trasparente. ideale per il montaggio su cavo e astine.  
 regal-baukastensystem, ecken aus glasgrünem polycarbonat, fachböden aus transparentem acryl. für stahlseile wie stangen geeignet.  
 modular system for racks, connectors made of glassgreen polycarbonate, shelves in transparent acrylic. for mounting on bars and wire.

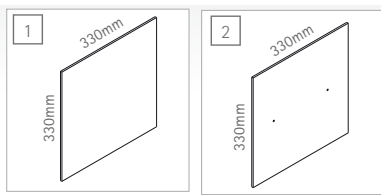
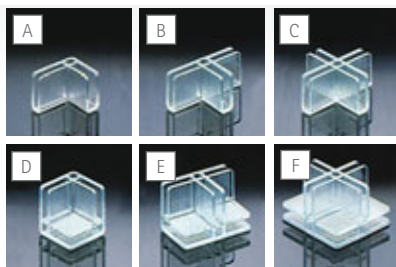

order for this combination  
 48x A  
 11x 1  
 6x 2

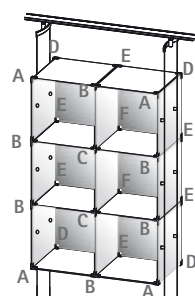

order for this combination  
 4x A  
 6x B  
 2x C  
 4x D  
 6x E  
 2x F  
 17x 1  
 6x 2

combinations



3 ripiano per astine realizzato in acrilico color ghiaccio.  
 regalfachboden für stabsystem aus frostweissem acryl.  
 shelf made of frosted white acrylic, for systems on bars.

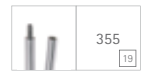
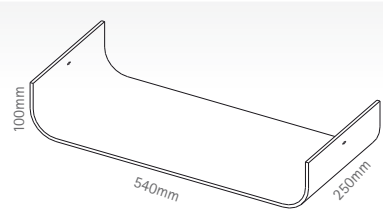

## soistes accessories

n° articolo | artikelnr. | product nr.

A	<b>FCONA</b>	connector A, 1pc	<b>0,90€</b>
B	<b>FCONB</b>	connector B, 1pc	<b>0,99€</b>
C	<b>FCONC</b>	connector C, 1pc	<b>1,10€</b>
D	<b>FCOND</b>	connector D, 1pc	<b>1,30€</b>
E	<b>FCONE</b>	connector E, 1pc	<b>1,65€</b>
F	<b>FCONF</b>	connector F, 1pc	<b>2,20€</b>
1	<b>FCON330PL</b>	shelf, 1pc	<b>15,50€</b>
2	<b>FCON2F330PL</b>	shelf, 1pc	<b>18,85€</b>
3	<b>YAL540BC</b>	shelf, 1pc	<b>79,00€</b>

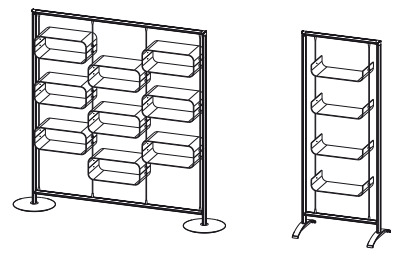



1

cart 900mm

250,-

**cart** soistes

MADE IN EU design by KD

**IT** cart è la struttura base mobile per la vostra presentazione su cavi o astine. profili in alluminio anodizzato color argento, piedini di metallo in pressofusione, color argento e 4 ruote stabili.

**DE** cart ist die mobile basis struktur für ihre präsentation am spannsel oder an der stange. silber eloxierter aluminiumprofilrahmen, füsse aus versilbertem metalldruckguss und 4 stabile leichtlaufrollen.

**EN** cart is the mobile base structure for your wire suspension presentations. silver anodised aluminium extrusions, feet made of silver-plated die-cast metal with 4 stable and smooth rolling wheels.

SOCA900

SOCA1500

profili in alluminio anodizzato, piedini di metallo in pressofusione, munito di 4 stabili ruote.

silber eloxiertes alu-profil, versilberter metalldruckguss, stabile rollen

silver anodised aluminium profile, silver-plated metal die-cast, stable coasters

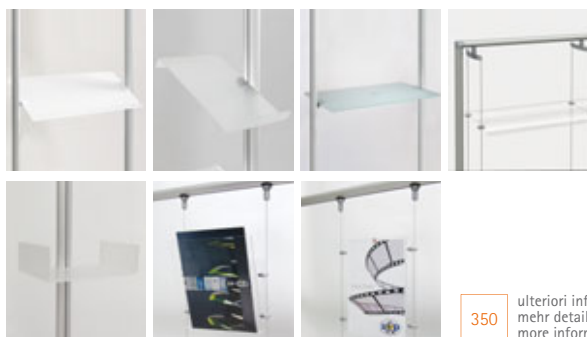

350 ulteriori informazioni pag. mehr details s. more information p.

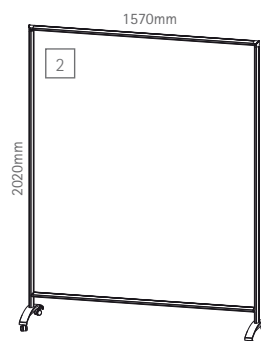
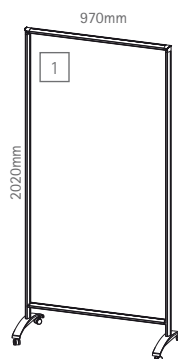

## cart soistes

n° articolo | artikelnr. | product nr.

1	SOCA900	cart 900mm, 1pc	250,00€
2	SOCA1500	cart 1500mm, 1pc	277,00€

shop



montaggio semplice e senza utensili: il peso stesso e il listello di pvc all'interno del profilo mantengono i ripiani stabilmente in posizione  
 einfach einhängen ohne werkzeug: eigengewicht und innenliegende pvc-schutzlitze halten fachböden in position  
 easily attached without any tools: the shelf's own weight and pvc protection lace keeps them in a stable position

# ripiano

MADE IN EU design by KD



- RIR400AL
- RIR600AL
- RIR900AL

profilo in alluminio anodizzato color argento, materiale per il montaggio incluso  
 silber eloxiertes aluminium profil, inkl. montagematerial  
 silver anodized aluminium profile, incl. mounting material

- RIV400240
- RIV600240
- RIV600320
- RIV900240
- RIV900320

vetro temperato di sicurezza, con angoli molati, logo in serigrafia  
 temperiertes sicherheitsglas mit facettenschliff, siebdruck logo  
 tempered glass with faceted edges, silk screen printed brand

**IT** design nobile adatto a qualsiasi tipo di arredamento per negozi, uffici, hotel o per casa: montare a parete il binario e agganciare semplicemente il ripiano in vetro. la particolare sfaccettatura degli angoli molati crea bellissimi effetti di luce. anche in combinazione con scaffali di altri materiali, ripiano è semplicemente splendido.

**DE** edles design für jede einrichtung ob shop, office, hotel oder home: ripiano rail wandmontieren und die glasfachböden einfach eingehängen. der besondere kantenschliff schafft brillante lichteffekte. aber auch mit ablagen aus anderen materialien sieht ripiano einfach toll aus.

**EN** noble design for every ambience in shops, offices, hotels or homes: wall mount the ripiano rail and simply attach the tempered glass shelves. the special design of the glass edges creates brilliant light effects. also with shelves in other materials ripiano is a real looker.

## ripiano

n° articolo   artikelnr.   product nr.		rail	
1	<b>RIR400AL</b>	rail 400mm, 1pc	<b>6,80€</b>
2	<b>RIR600AL</b>	rail 600mm, 1pc	<b>9,90€</b>
3	<b>RIR900AL</b>	rail 900mm, 1pc	<b>14,70€</b>
<b>glasses</b>			
4	<b>RIV400240 *</b>	glass 400x240mm, 1pc	<b>11,50€</b>
5	<b>RIV600240 *</b>	glass 600x240mm, 1pc	<b>17,50€</b>
6	<b>RIV600320 *</b>	glass 600x320mm, 1pc	<b>20,00€</b>
7	<b>RIV900240 *</b>	glass 900x240mm, 1pc	<b>22,00€</b>
8	<b>RIV900320 *</b>	glass 900x320mm, 1pc	<b>26,50€</b>

\* in vendita da febbraio 2011 | auslieferung ab februar 2011 | on sale from february 2011

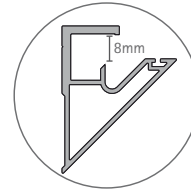

il nostro consiglio: provate ripiano anche in combinazione con scaffali in altri materiali come legno o pietra

unser tip: probieren sie ripiano in gleicher abmessung aber mit anderen materialien wie holz oder stein

our tip: try ripiano in same size but with other materials such as wood or stone.



2 + 5

rail 600 + glass 600x240mm

**27,40**







340-345 346 348 350 352 354 356 359 360 364 365 366 367 368 369 370 371



**sarto** soistes

MADE IN EU design by KD



1

SOSA650VE

alluminio anodizzato, connettori e piedini in zamac color argento, con ruote, ripiano in vetro temperato con serigrafia in colore bianco e con marchio sul retro

eloxiertes aluminium, verbinder und füsse metall-druckguss, rollen, ablage temperiertes glas mit rückseitig weissem siebdruck und marke

anodised aluminium, metal die-cast connectors and feet, with coasters, tempered glass shelf with white silk screen print and brand on bottom side

710mm

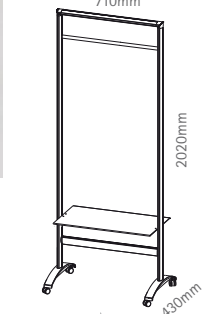

2020mm

420mm

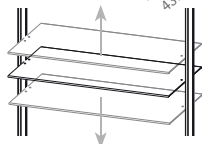
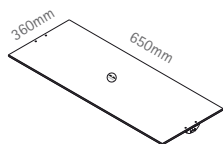

1

sarto soistes

240,-

**IT** espositore mobile per i vestiti oppure ideale come guardaroba nel backstage: ecco il vostro sarto soistes. i profili in alluminio anodizzato color argento su ruote e un ripiano, realizzato in vetro temperato, rendono questo display un espositore esclusivo e sempre alla moda.

**DE** mobiler präsentier für kleidung oder auch garderobe im backstage-bereich ist ihr sarto soistes. silber eloxierte aluminiumprofile auf leichtlaufrollen inklusive einer ablage aus temperiertem glas machen dieses display zu einem exklusiven mode-präsentier.

**EN** mobile display for clothes or even as a back stage wardrobe: that's your soistes. the profiles, in silver anodised aluminium on wheels with a shelf, made of tempered glass, makes this an exclusive and fashionable display.

**sarto soistes**

n° articolo | artikelnr. | product nr.

1 **SOSA650VE**

sarto soistes, 1pc **240,00€**



1  
store soistes  
290,-

**IT** store soistes è la libreria mobile, robusta e resistente. i profili in alluminio anodizzato, color argento e i 3 ripiani di vetro temperato, si reggono su piedini di gomma rigida. ogni ripiano si può disporre a libera scelta lungo tutta la lunghezza del profilo.

**DE** ganz robust und belastbar ist store das mobile regal. silber eloxierte aluminiumprofile und drei temperierte glasfachböden stehen sicher auf hartgummifüßen. jede ablage ist stufenlos höhenverstellbar.

**EN** extremely robust, that's store the mobile rack. silver anodised aluminium and three shelves made of tempered glass on hard rubber feet. every shelf is adjustable in height.



store soistes

MADE IN EU design by KD

SOST650VE

profili in alluminio anodizzato color argento, connettori e piedini in zamac color argento, ripiani in vetro temperato, serigrafato color bianco con marchio sul retro  
silber eloxierte aluminiumprofile, versilberte verbinder und füsse aus metalldruckguss, mit hartgummifüßen, temperierte sicherheitsglas fachböden, unterseite weiss besiedruckt mit logo

silver anodised aluminium profiles, silver-plated, die-cast metal connectors and feet, with hard rubber pads, tempered glass shelves with white silk screen print with brand on bottom side

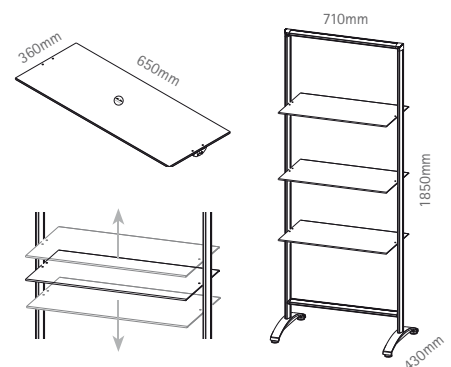

store soistes

n° articolo | artikelnr. | product nr.

1 SOST650VE

store soistes, 1pc 290,00€



# connector

 MADE IN EU design by KD

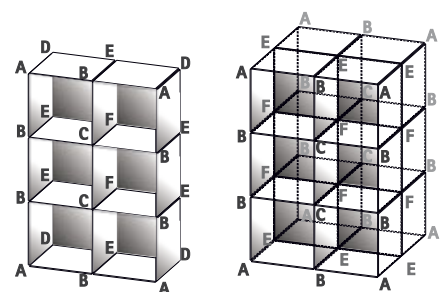
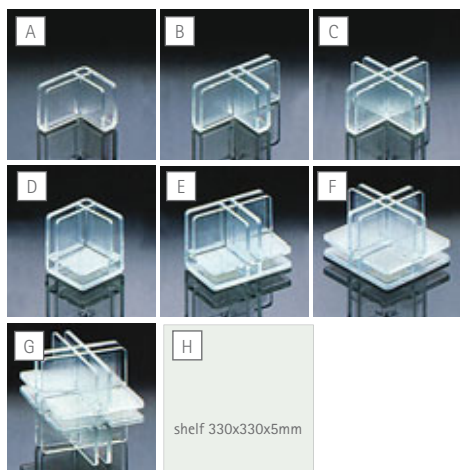

**IT** sistema modulare per vetrine ad incastro. realizzate la vostra personalissima vetrina con pannelli da 5mm ed i fissaggi angolari connector in policarbonato color vetro. a seconda della forma e delle dimensioni della vostra applicazione, ordinate i singoli pezzi che vi servono, gli esempi qui riproposti vi aiutano nella scelta del fissaggio giusto. ideale per negozi, showroom, musei, vetrine e anche per l'arredamento di casa.

**DE** schlagfeste eckverbinder aus glasgrünem polycarbonat für cuben nach dem baukasten-system. gestalten sie ihre persönliche vitrine mit connector eckhaltern und 5mm-paneeelen. die beispelskizzen helfen Ihnen bei der richtigen auswahl der entsprechenden eckverbinder. eine tolle sache für shop, showroom, museum, schaufenster und homebereich.

**EN** shock-resistant panel-connector made of glassgreen polycarbonate for modular cube systems. create your personal vitrine with 5mm-panels and connectors. the drawings with examples help you choosing the right parts. it's a peach for shop, showroom, museum, shop window and home as well.

## connector

n° articolo | artikelnr. | product nr.

<b>A</b>	<b>FCONA</b>	1 pc	<b>0,90€</b>
<b>B</b>	<b>FCONB</b>	1 pc	<b>0,99€</b>
<b>C</b>	<b>FCONC</b>	1 pc	<b>1,10€</b>
<b>D</b>	<b>FCOND</b>	1 pc	<b>1,30€</b>
<b>E</b>	<b>FCONE</b>	1 pc	<b>1,65€</b>
<b>F</b>	<b>FCONF</b>	1 pc	<b>2,20€</b>
<b>G</b>	<b>FCONG</b>	1 pc	<b>2,90€</b>
<b>H</b>	<b>FCON330PL</b>	shelf, transparent acrylic, 330x330x5mm, 1 pc	<b>15,50€</b>



# vista

MADE IN EU design by KD

**IT** vetrina della serie soistes con 3 ripiani in acrilico trasparente per la presentazione di piccoli oggetti. il foglio in polycarbonato flessibile puo essere rimosso completamente estratto. vista, inoltre, può essere facilmente personalizzato laminando direttamente il foglio sul retro. i 3 ripiani in acrilico trasparente sono regolabili in altezza. i materiali di prima scelta caratterizzano vista: coperchi, profili e pannelli in alluminio anodizzato color argento. base in metallo verniciato a polvere color argento; i fissaggi dei ripiani sono in zamac color argento.

**DE** vitrine aus der soistes linie mit 3 ablagen aus transparentem acrylglas zur präsentation kleinerer objekte. die polycarbonatfolie ist front- und rückseitig abnehmbar. durch direktes aufkaschieren auf die rückwand können sie vista ganz einfach personalisieren. die 3 acryl-ablagen können stufenlos höhenverstellt werden. hochwertige materialien zeichnen vista aus: die abdeckungen oben und unten, das paneel sowie die profile sind aus silber eloxiertem aluminium. die basis ist aus silber pulverbeschichtetem metall. aus versilbertem metaldruckguss sind die ablagen halter.

**EN** with vista the showcase from the soistes series with 3 shelves made of transparent acrylic you present especially smaller objects perfectly. the flexible transparent cover on front and rear can be taken off completely. you can customize your vista easily by laminating the rear cover easily. the 3 acrylic shelves can be adjusted infinitely in height easily. the use of high-grade materials is what makes vista special: top and bottom cover, profiles and panels are made of silver anodized aluminium. the base is in silver powder coated metal, while the shelf supports are made of silver-plated metal die-cast.

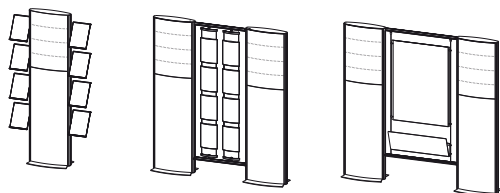

## vista

n° articolo | artikelnr. | product nr.

1 SOVS1900500

vista, 1pc 570,00€



SOVS1900500

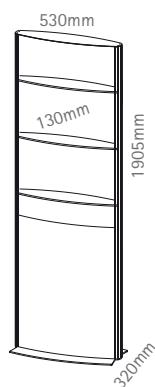

profili e pannelli in alluminio anodizzato color argento, ripiani in acrilico, vetrina in polycarbonato, base in metallo verniciato a polvere

silber eloxierte aluminium profile und paneele, acrylglas ablage, polycarbonat schein, pulverlackbeschichtete metall basis

anodised aluminium, connectors and feet in silver coloured zamac, on wheels, shelves made of screen printed white tempered glass with brand name on the rear.



# vetrina top

MADE IN EU controlled by KD

1  
vetrina top

1390,-

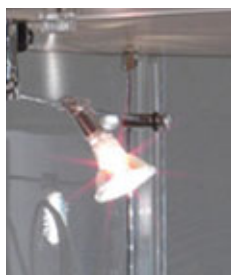

lampade alogene a basso voltaggio orientabili  
verstellbare niedervolt halogen leuchten  
adjustable halogen spot lamps



antina protetta con serratura  
flügeltüre mit schloss gesichert  
doors equipped with lock

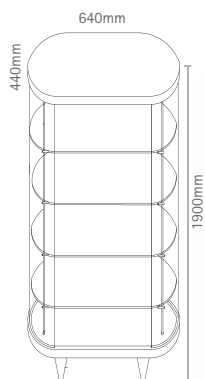
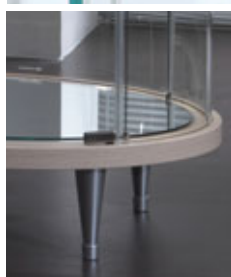

**IT** vetrinetta illuminata rifinita al top: tutti i ripiani sono regolabili sia in altezza che per inclinazione. i 2 spot alogeni illuminano perfettamente gli oggetti esposti su ogni ripiano. il vetro temperato e il fondo a specchio forniscono luminosa trasparenza e un tocco di eleganza in più. il pannello di copertura e quello di fondo sono in rovere schiarito.

**DE** vitrine in topausführung mit beleuchtung: alle fachböden können sowohl in höhe wie auch neigung individuell eingestellt werden. 2 halogen-spots je ablage leuchten jedes objekt optimal aus. temperiertes glas und bodenspiegel garantieren transparente optik und elegantes flair. boden- und deckenplatte aus mdf mit eiche gebleicht laminat.

**EN** high quality glass display case with lighting: all shelves can be regulated in height or inclined individually. 2 halogen spot lights per shelf illuminate perfectly all objects on display. tempered glass and the mirror on the bottom guarantee a transparent look and elegant flair. top and bottom panel made of mdf with white oak laminate.



## vetrina top

n° articolo | artikelnr. | product nr.

1 VTT6444RSB \*)

vetrina top, 1pc 1390,00€

\*) spedizione extra per merce voluminosa, non può essere consegnata assieme ad altri prodotti.

\*) extra sperrgut-versand, kann nicht mit anderen artikeln versandt werden.

\*) extra bulk material transport, cannot be shipped together with other items.



2  
vetrina big  
600,-



1  
vetrina small  
530,-

## vetrina

MADE IN EU controlled by KD 

protetta da apposita serratura  
mit türschloss gegen unbefugtes  
öffnen gesichert  
no unauthorized access thanks to  
the integrated locks



montata su rotelle per una  
maggiore mobilità  
rollen für flexiblen einatz  
mobil thanks to the wheels



**IT** vetrinetta rettangolare con illuminazione interna realizzata con vetro temperato, MDF verniciato argento, robuste rotelle e 4 ripiani: ideale per presentazioni in showroom, negozi o uffici, ma anche per fiere ed altri eventi in cui esporre oggetti in una cornice particolarmente avvincente.

**DE** rechteckige vitrine mit deckenleuchten: temperiertes glas, silberlackiertes MDF und stabile rollen zeichnen diese vitrinen aus. 4 fächböden zur präsentation in showroom, shop und office. auch auf messen und anderen events oder ausstellungen ein besonderer rahmen für ihre präsentation.

**EN** square glass case with ceiling lighting: tempered glass, silver laminated mdf and stable wheels characterize these show cases. 4 shelves for presentation in showrooms, shops and offices. also for fairs, events and other exhibitions, a unique display for your presentation.

VTR6040AR VTR8040AR



ELECTRONIC

### vetrina

n° articolo | artikelnr. | product nr.

1	VTR6040AR *)	vetrina small 1pc	530,00€
2	VTR8040AR *)	vetrina big 1pc	600,00€

\*) spedizione extra per merce voluminosa, non può essere consegnata assieme ad altri prodotti.

\*) extra sperrgut-versand, kann nicht mit anderen artikeln versandt werden.

\*) extra bulk material transport, cannot be shipped together with other items.

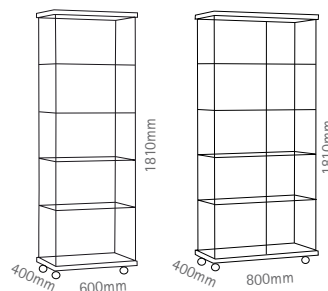



340-345 346 348 350 352 354 356 359 360 362 363 364 365 366 367 370 371



# miura stool & table

design by konstantin gric, produced by plank winner 100% design blueprint best product award 2005

**IT** design vincente di konstantin gric. sgabello impilabile in polipropilene rinforzato. in linea con il sgabello miura il tavolo ha una struttura a tre gambe in acciaio zincato verniciato a polvere. sgabelli impilabili e tavolini pieghevoli per meno ingombro sia per il trasporto che per lo stoccaggio. entrambi adatti per uso interno ed esterno.

**DE** gewinnendes design von konstantin gric: stapelbarer barhocker aus verstärktem polypropylen. passend dazu der miura table: dreibeiniges tischgestell aus verzinktem, pulverbeschichtetem stahl. stapelbar und volumensparend bei transport und lagerung. beide produkte für innen- wie aussenbereich.

**EN** winning design by designer konstantin gric: stackable stool in reinforced polypropylene. in line with miura stool is the miura table made of varnished galvanised steel. thanks to the locking system the table is foldable and saves space during transport and storage as well. both items are for in- and outdoor.



## miura stool

n° articolo | artikelnr. | product nr.

1	MIURA1027	curry yellow, 1pc	160,00€
2	MIURA2004	pure orange, 1pc	160,00€
3	MIURA3020	signal red, 1pc	160,00€
4	MIURA3009	oxide red, 1pc	160,00€
5	MIURA9002	white grey, 1pc	160,00€
6	MIURA5013	cobalt blue, 1pc	160,00€
7	MIURA7021	black, 1pc	160,00€

## miura table

n° articolo | artikelnr. | product nr.

8	TMIURA3020L	signal red, 1pc	390,00€
9	TMIURA9002L	grey white, 1pc	390,00€
10	TMIURA7021L	black grey, 1pc	390,00€

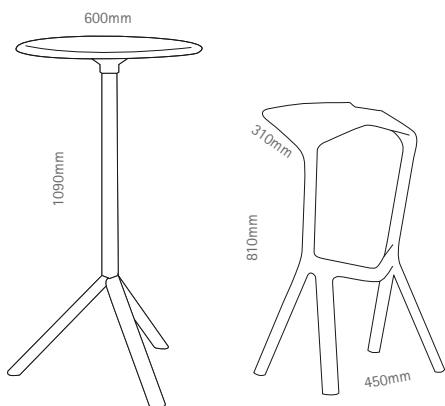

# wave

MADE IN EU design by KD



1  
wave  
182,-

**IT** create veri e propri piani di appoggio modulari grazie ai tavolini wave : ondulari, a cerchio, a semicerchio oppure in segmenti, a seconda delle proprie esigenze. Utilizzate wave in sale di attesa, decorate stand fieristici oppure create eleganti barriere modulari per eventi particolari. Materiali di alta qualità, come alluminio anodizzato, rivestimento in abs cromato e tavolino in mdf verniciato color argento, rendono wave l'accessorio perfetto in ogni ambiente e in ogni spazio da arredare.

**DE** mit wave tischen können sie modular theken zaubern: wellenförmig, als kreise, halbkreise oder segmente ganz nach bedarf. binden sie wave in wartebereiche ein, gestalten sie messestände oder absperrungen bei events. hochwertige materialien wie eloxiertes aluminium, matt verchromter trittschutzring und silberlackierte tischplatte machen wave zu einem besonderen highlight der raumgestaltung.

**EN** create modular counters with wave tables: s-shaped, in circles, semi-circles or segments always according to your needs. integrate wave into waiting areas, create fair stands or barriers for events. high-grade materials used; silver anodized aluminium, satin chrome-plated abs step-on protection and silver varnished table top make your wave a very special highlight for interior decoration.

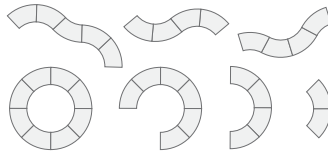

176 ulteriori informazioni pag. mehr details s. more information p.

## wave

n° articolo | artikelnr. | product nr.

1 **STCWAVE** set wave alu, 1pc **182,00€**

**IT** grazie a rondo, dalla serie stopper, potete arredare i vostri ambienti con tavolini e punti di appoggio eleganti e funzionali. base con rivestimento di protezione in abs cromato; tavolini disponibili in vetro e in mdf verniciato color argento: usati in combinazione l'uno con l'altro, i due tavolini vi danno la possibilità di sfruttare una superficie personalizzabile. in aggiunta, potete rendere personalizzabile anche la base, grazie all'insero centrale in vetro da usare in combinazione con il rivestimento laterale di protezione. rondo è semplicissimo da montare, rendendosi così insostituibile per fiere, eventi, negozi, showroom e uffici.

**DE** mit den rondo tischen aus dem stopper programm mehrwert sichern: basis mit mattverchromtem trittschutzring aus abs. die tischplatten sind in glas oder silberlackiertem mdf erhältlich. in der kombination beider ausführungen miteinander erhalten sie eine schnell personalisierbare werbefläche. dazu passt die ebenfalls schnell mit printinlay gestaltete basis mit glaseinsatz. rondo ist schnell aufgestellt und empfiehlt sich für messen, events, shop, showroom und office.

**EN** gain publicity space with the rondo tables: base with a satin chrome-plated step-on protection made of abs. the table tops are available in glass or silver-varnished mdf. with the combination of both table tops you get a quick customizable extra marketing space. in this version the base can also be customized with a print inlay in no time at all. rondo sets up quickly and is your perfect choice for fairs, events, shops, offices and showrooms.

177 ulteriori informazioni pag. mehr details s. more information p.

## rondo

n° articolo | artikelnr. | product nr.

2 **STCRONDOVE \*** set rondo table top glass, 1pc **142,00€**  
 3 **STCRONDOMDF \*** set rondo table top mdf, 1pc **146,00€**  
 4 **STCRONDOVEMDF \*** set rondo table top glass and mdf, 1pc **181,00€**

\* fino ad esaurimento scorte | solange vorrat reicht | while stock last

# rondo

MADE IN EU design by KD



3  
rondo  
146,-





# space

MADE IN EU design by KD



regolatore d'intensità: per un'illuminazione soffusa o più vivace

dimmer für stufenlose regelung des lichts: von sanft bis hell

dimmer infinitely variable for softer or brighter lighting

your own print!



2100mm

300mm

**IT** space lampada gonfiabile realizzata con uno speciale telo superfine. grazie ad un ventilatore invisibile, space si gonfia e viene tenuta in piedi dall'aria.

**DE** space aufblasbare leuchte in federleichtem spezialstoff. dank des eingebauten ventilators wird space mit luft gefüllt und in form gehalten.

**EN** space inflatable lamp made of extra-thin airproof fabric. thanks to an invisible ventilator space inflates and stays vertical.



## space

n° articolo | artikelnr. | product nr.

1	SP2150300BL		space blue, 1pc	259,00€
2	SP2150300RE		space red, 1pc	259,00€
3	SP2150300GR *		space green, 1pc	259,00€
4	SP2150300WH		space white, 1pc	259,00€
5	SP2150300YE		space florescent yellow, 1pc	259,00€
6	SP2150300OR		space florescent orange, 1pc	259,00€

\* fino ad esaurimento scorte | solange vorrat reicht | while stock last



1  
ping meets pong

1499,-

# ping meets pong

MADE IN EU design by walking chair, vienna



**IT** tavolo da gioco, da pranzo e da lavoro tutto in uno. in primo luogo tavolo da ping pong, con una rete mobile: voi stabilite il numero di giocatori, voi fissate le regole. subito dopo ping meets pong diventa un serio e spazioso tavolo da conferenza. infine diventa un piacevole tavolo da pranzo, per i pasti quotidiani, per le feste con gli amici e per tutte le vostre occasioni speciali. tutto ciò è reso possibile dalla sfera al centro del tavolo, di 2 m di diametro, dove si inseriscono la rete mobile o il tavolino girevole. ping meets pong è disponibile in blu e in nero, il tavolino centrale è bianco. la superficie del tavolo è ricoperta da uno strato di melamina, la struttura è in acciaio laccato di bianco. per uso interno.

**DE** sportgerät, festliche tafel und konferenztisch in einem. erst ein pingpong-tisch mit frei drehbarem netz. sie bestimmen die teamstärke, sie machen die spielregeln. dann ein seriöser auftritt als konferenztisch. und schliesslich eingedeckt ein ess-tisch für alltägliche mahlzeiten, fröhliche runden mit freunden oder festliche gelegenheiten. alles möglich durch das kugellager im zentrum der Ø2m tischplatte, in das entweder das pingpong netz oder der Ø1m aufsatz-tisch frei drehbar eingesetzt werden. ping meets pong gibt es in blau und schwarz, den aufsatz-tisch in weiss. tischplatten melamin-beschichtet, aufbau stahl mit weisser pulverlack-beschichtung. indoor-möbel.

**EN** the all-in-one table for ping-pong, conferences and dinners. first you have a ping-pong table with free turning net. you set the number of the team members, you play by your own rules. right after ping meets pong becomes a respectable conference table. and at least it is a dining table for everyday life, for cheerful meetings with friends or for banquets on festive days. in the middle of the Ø2m table top a ball-bearing renders all this possible. the ping-pong net or the Ø1m accessory turntable insert freely rotatable into the bearing. ping meets pong is available in blue and black, the turntable in white. plates are melamine coated, table base is white powder coated steel. for indoor use.

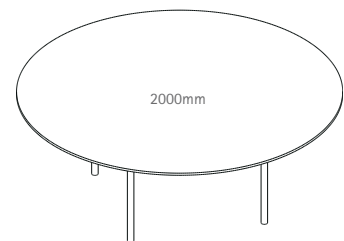

## ping meets pong

n° articolo | artikelnr. | product nr.

1	<b>BLUPINGPONG *</b>	ping meets pong blue, 1pc	1499,00€
2	<b>NEROPINGPONG *</b>	ping meets pong black, 1pc	1499,00€

\* fino ad esaurimento scorte | solange vorrat reicht | while stock last

shop